

TO-92

Voltage Regulator in a TO-92 Plastic Package.

100mA,

3-Terminal regulators, output current up to 100 mA, internal thermal overload protection and short-circuit limiting.

Voltage Regulator.

/ / **Equivalent Circuit or Application Circuit**



Parameter	Symbol	Rating	Unit
Input voltage	$V_I$	30	V
Output current	$I_O$	100	mA
Operating virtual Junction temperature	$T_J$	0 125	
Power Dissipation	$P_D$	500	mW
Storage temperature range	$T_{stg}$	-65 150	

Parameter	Symbol	Test Conditions	Min	Typ	Max	Unit
Output voltage	$V_O$	$I_O = 40mA$ $T_j = 25$	8.64	9	9.36	V
		$I_O = 1mA$ to 40mA $V_I = 11.5V$ to 23V	8.55	9	9.45	V
		$I_O = 1mA$ to 70mA $V_I = 15V$	8.55	9.02	9.45	V

V(n03 T21

Ou7.02

/ Electrical Characteristic Curve

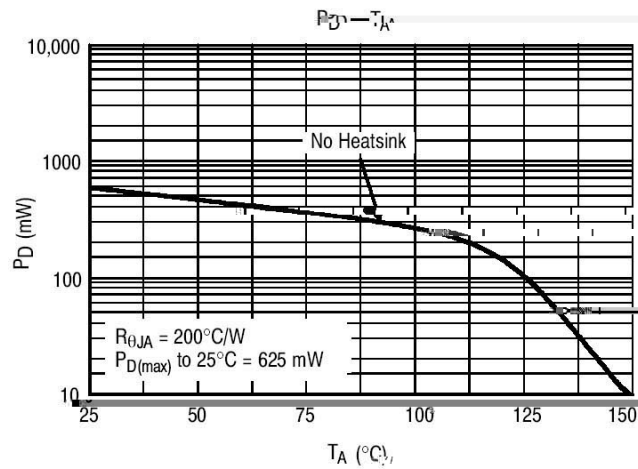
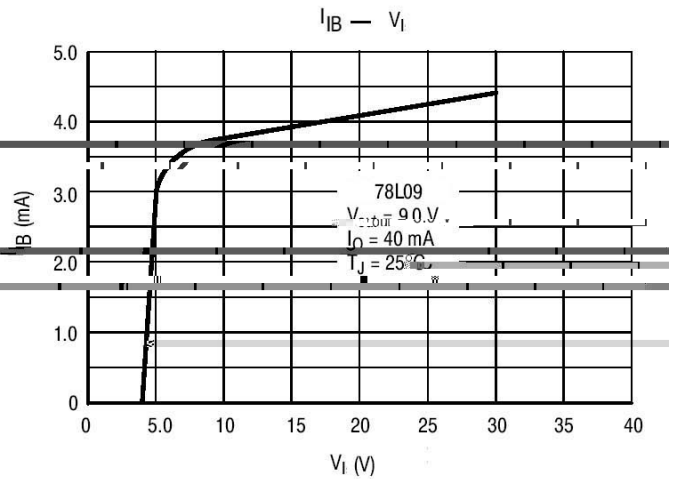
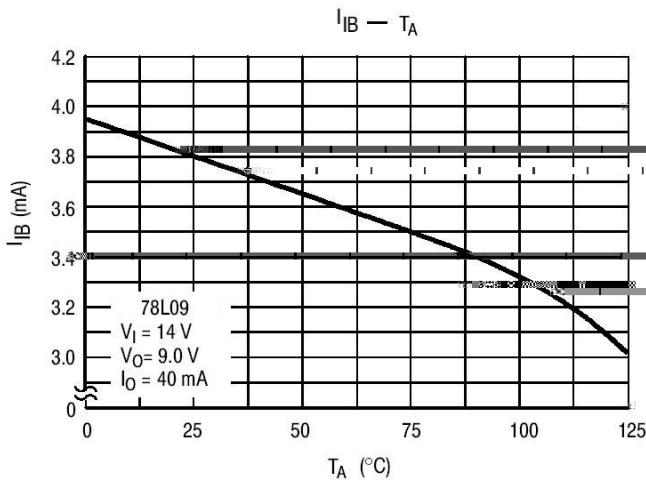
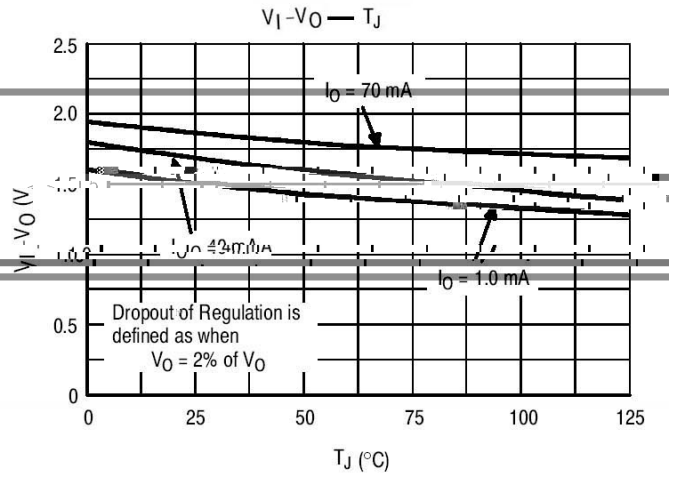
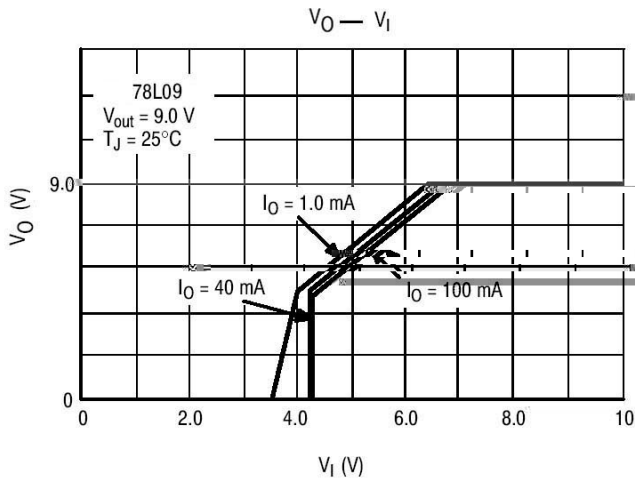

/ Package Dimensions

TO-92

Unit: mm

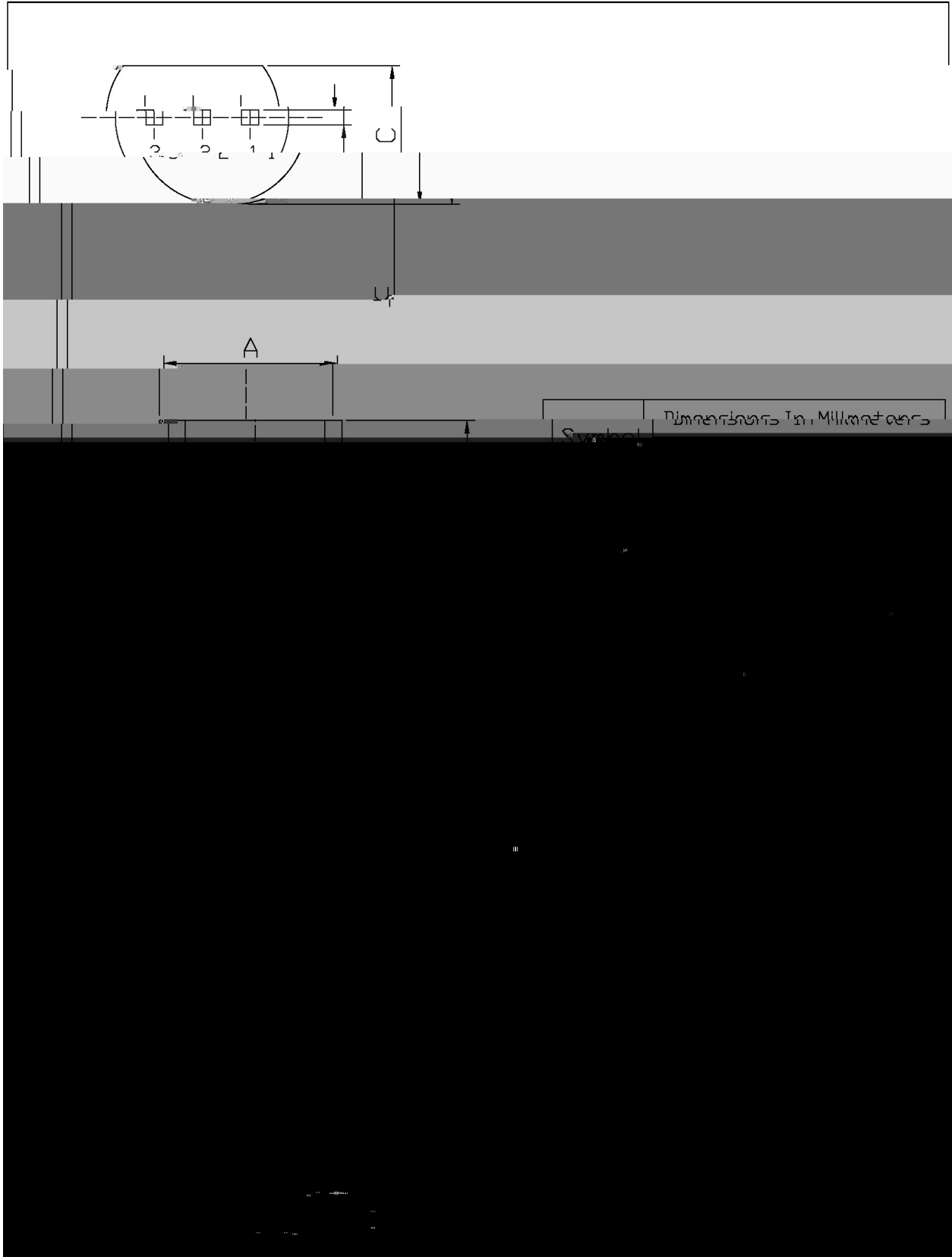

/ Marking Instructions

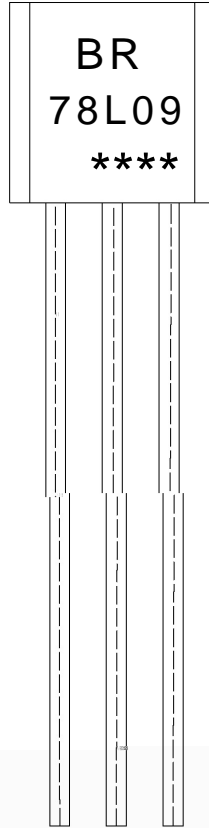

BR

78L09

\*\*\*\*

Note:

BR: Company Code.

78L09: Product Type.

\*\*\*\*: Lot No. Code, code change with Lot No.

( ) / Temperature Profile for Dip Soldering(Pb-Free)



Note:

- |   |       |     |           |        |   |
|---|-------|-----|-----------|--------|---|
| 1 | 25    | 150 | 60        | 90sec; | 1.Preheating:25~150 , Time:60~90sec.    |
| 2 | 255±5 |     | 5±0.5sec; |        | 2.Peak Temp.:255±5 , Duration:5±0.5sec. |
| 3 |       | 2   | 10        | /sec.  | 3. Cooling Speed: 2~10 /sec.            |

/ Resistance to Soldering Heat Test Conditions

270±5                      10±1 sec.                      Temp:270±5                      Time:10±1 sec

/ Packaging SPEC.

/ BULK

Package Type 封装形式	Units 包装数量					Dimension 包装尺寸 (unit: mm3)		
	Units/Bag 只/袋	Bags/Inner Box 袋/盒	Units/Inner Box 只/盒	Inner Boxes/Outer Box 盒/箱	Units/Outer Box 只/箱	Bag 袋	Inner Box 盒	Outer Box 箱
TO-92	1,000	10	10,000	5	50,000	135×190	237×172×102	560×245×195
	1,000	10	10,000	10	100,000	135×190	237×172×102	560×245×375

/ AMMO

Package Type 封装形式	Units 包装数量					Dimension 包装尺寸 (unit: mm3)	
	Units/tape 只/纸带	Tape/Inner Box 纸带/盒	Rows/Inner Box 纸带层/盒	Inner Boxes/Outer Box 盒/箱	Units/Outer Box 只/箱	Inner Box 盒	Outer Box 箱
TO-92	3,000	1	120	10	30,000	328×230×42	小箱 480×346×235, 大箱 547×407×268

/ Notices