

/ Descriptions

/ Features

(%8#

/ Applications

/ / Equivalent Circuit or Application Circuit



/ Pinning

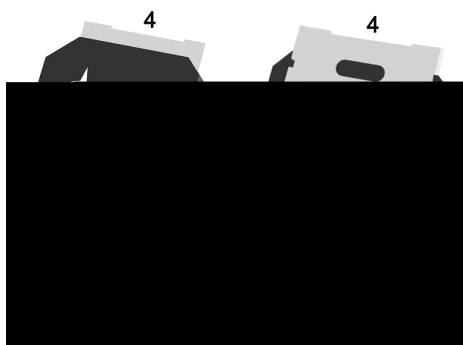

/ Marking

/ Electrical Characteristic Curve

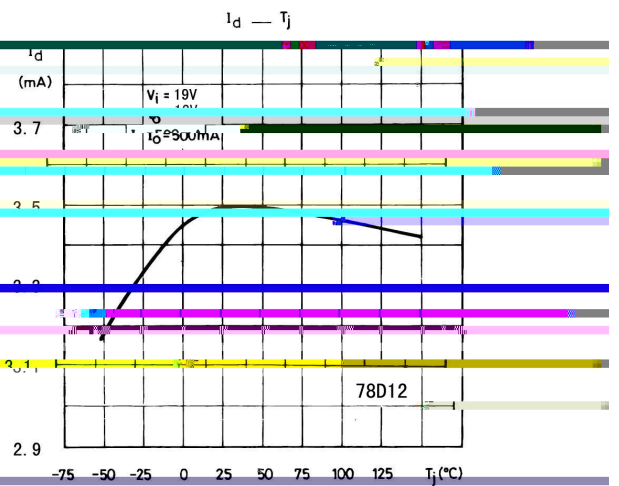
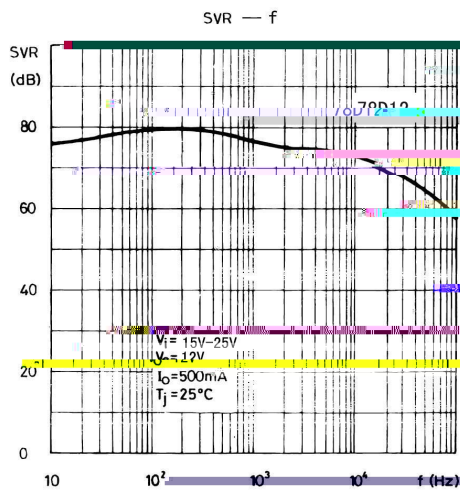
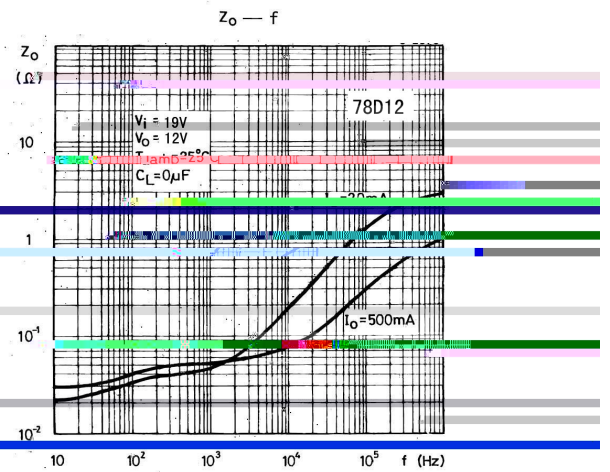
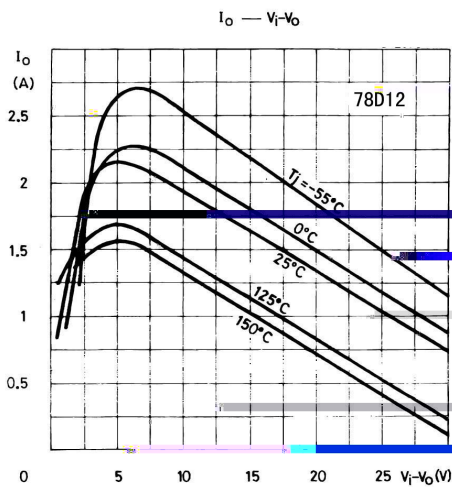
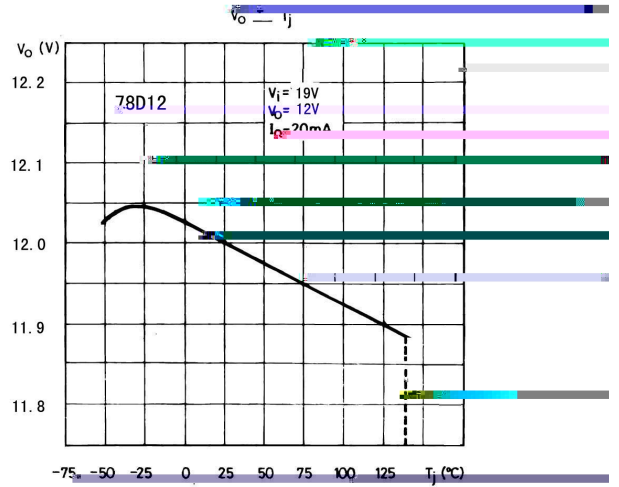
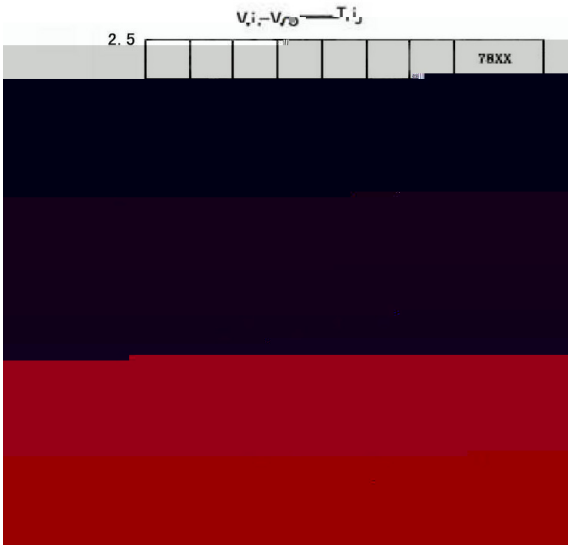

/ Marking Instructions

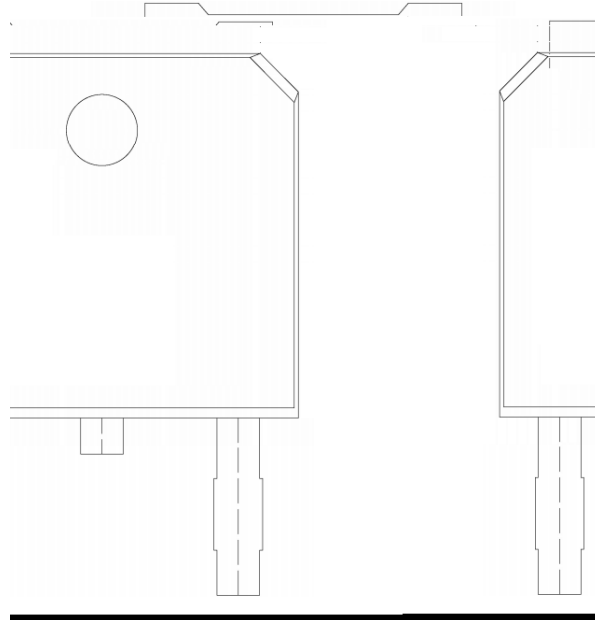

91

. / ; ()

() / Temperature Profile for IR Reflow Soldering(Pb-Free)

±

±

±

±

