

40uVrms 10Hz~100kHz
150mV@150mA
50uA
300mA
75dB@1kHz

2.0V~6.0V
1.2V~5.0V
2%

SOT23-5

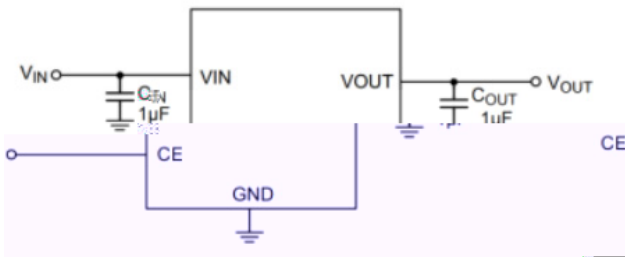

BRCO2600MEQ

Rev.A Dec.-2023

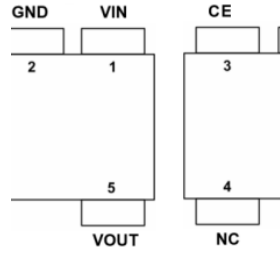
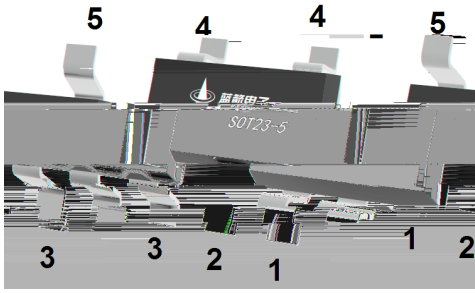

	V_{IN}		2.0		6.0	V

BRCO2600MEQ

/ Electrical Characteristic Curve



/ Package Dimensions

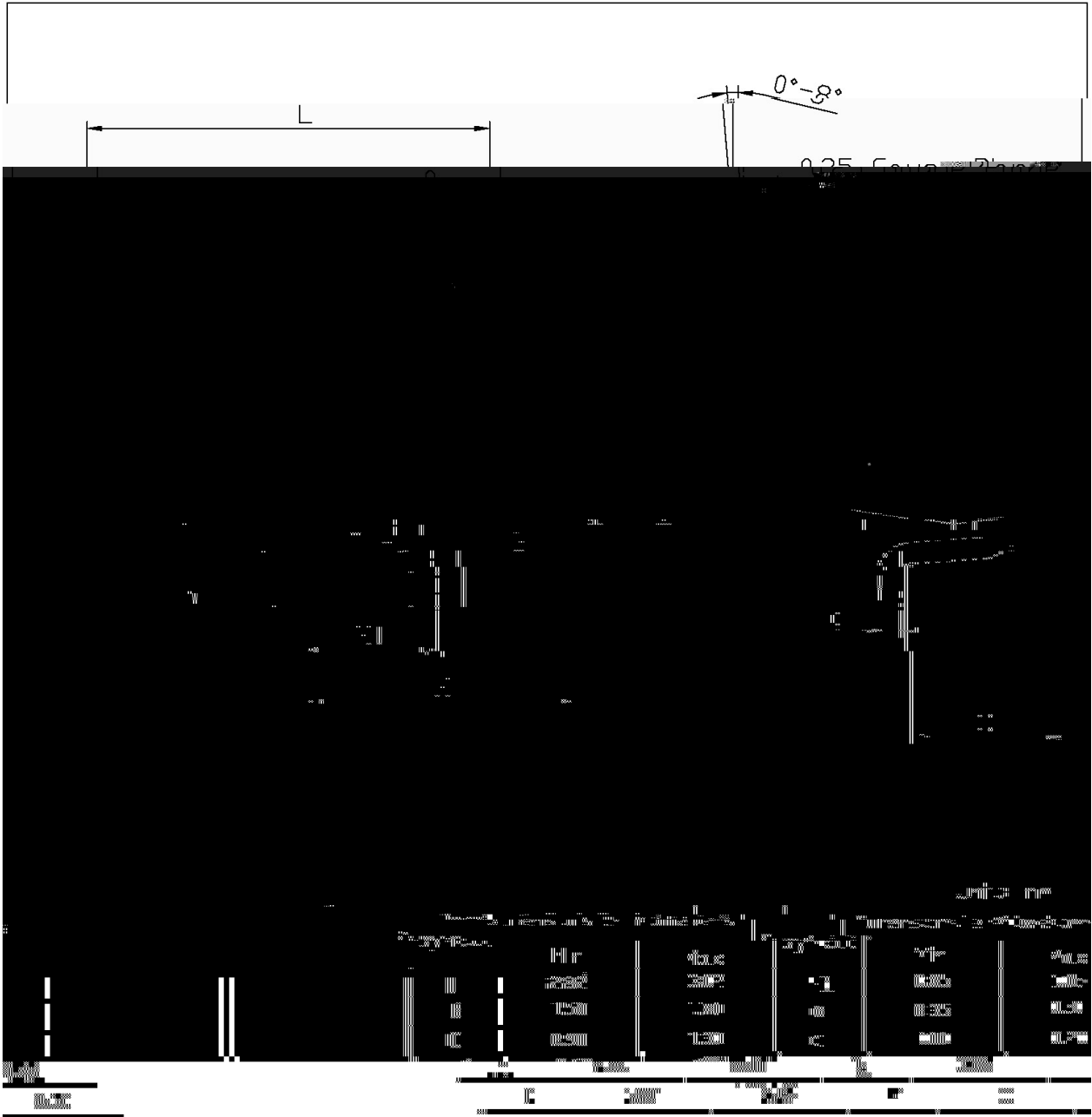

/ Marking Instructions

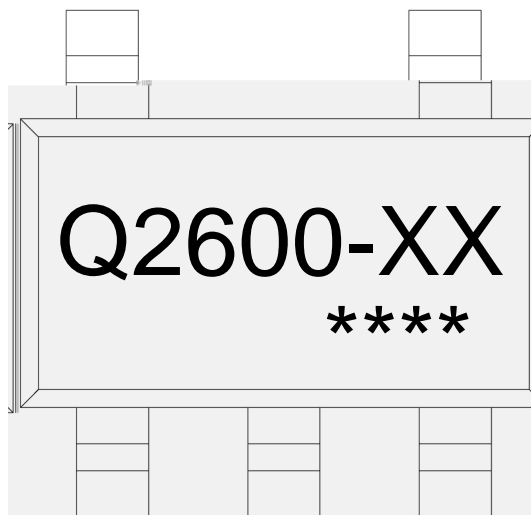

BRCO2600MEQ-1.2	Q2600-12
BRCO2600MEQ-1.5	Q2600-15
BRCO2600MEQ-1.8	Q2600-18
BRCO2600MEQ-2.5	Q2600-25
BRCO2600MEQ-2.8	Q2600-28
BRCO2600MEQ-3.0	Q2600-30
BRCO2600MEQ-3.3	Q2600-33

() / Temperature Profile for IR Reflow Soldering(Pb-Free)

Note:

- 1 150 200 60 120sec; 1.Preheating:150~200 , Time:60~120sec.
- 2 255 5 5 0.5sec; 2.Peak Temp.:255 5 , Duration:5 0.5sec.
- 3 2 10 /sec. 3. Cooling Speed: 2~10 /sec.

/ Resistance to Soldering Heat Test Conditions

260 5 10 1 sec. Temp.:260±5 Time:10±1 sec

/ Packaging SPEC.

/ REEL

Package Type	Units					Dimension (unit mm ³)		
	3,000	10	30,000	4	120,000	7 x8	210x205x205	445x435x230
SOT23-5/6	3,000	10	30,000	4	120,000	7 x8	210x205x205	445x435x230