

BRCS200P03DP

Rev.A Aug.-2022

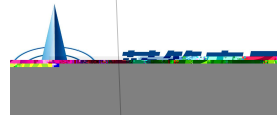

DATA SHEET

| | | | | | |
|--|--|--|--|--|--|
| | | | | | |
|--|--|--|--|--|--|

A

2022-08.01

ALL

AOS-AOD4189

L

BRCS200P03DP

Rev.A Aug.-2022

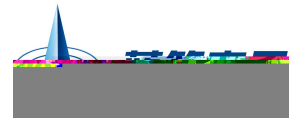

DATA SHEET

/ Descriptions

TO-252 P MOS
P-CHANNEL MOSFET in a TO-252 Plastic Package.

/ Features

Low On-Resistance, fast switching, HF Product.

/ Applications

DC/DC

Power Management of Industrial DC/DC Converter.

/ Equivalent Circuit



/ Pinning

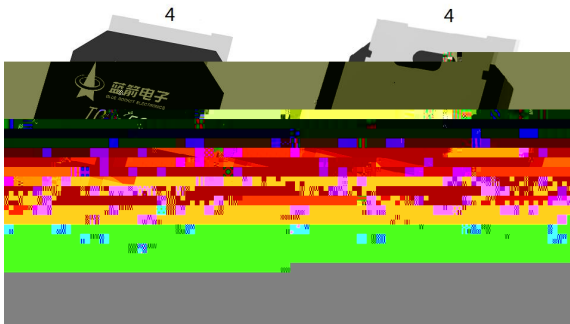

PIN1 G PIN 2 D PIN 3 S PIN 4 D

/ Marking

See Marking Instructions.



DATA SHEET

| |
|------|
| Unit |
| V |
| A |
| A |
| |

| Parameter | Symbol | Test Conditions | Min |
|-----------|--------|-----------------|-----|
|-----------|--------|-----------------|-----|

BRCS200P03DP

Rev.A Aug.-

/ Electrical Characteristic Curve

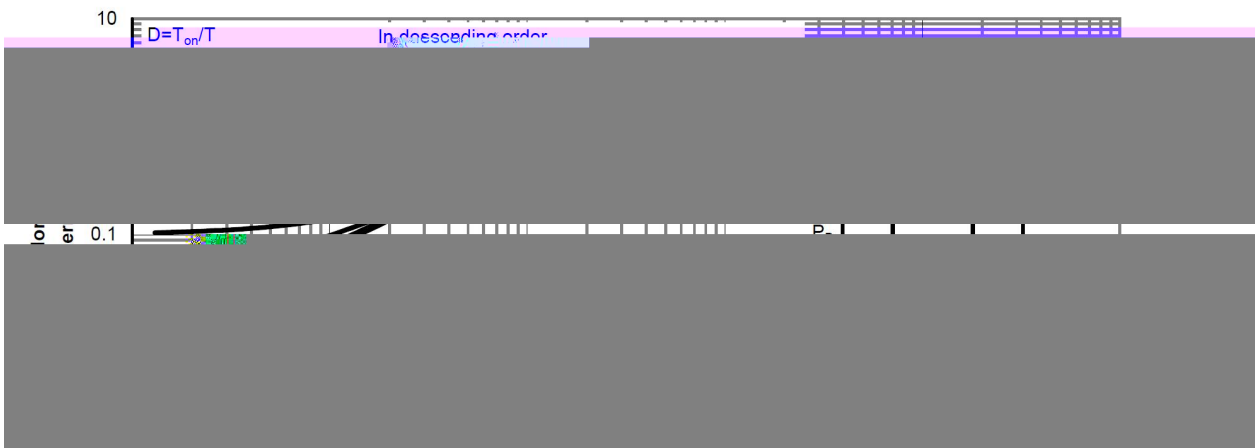
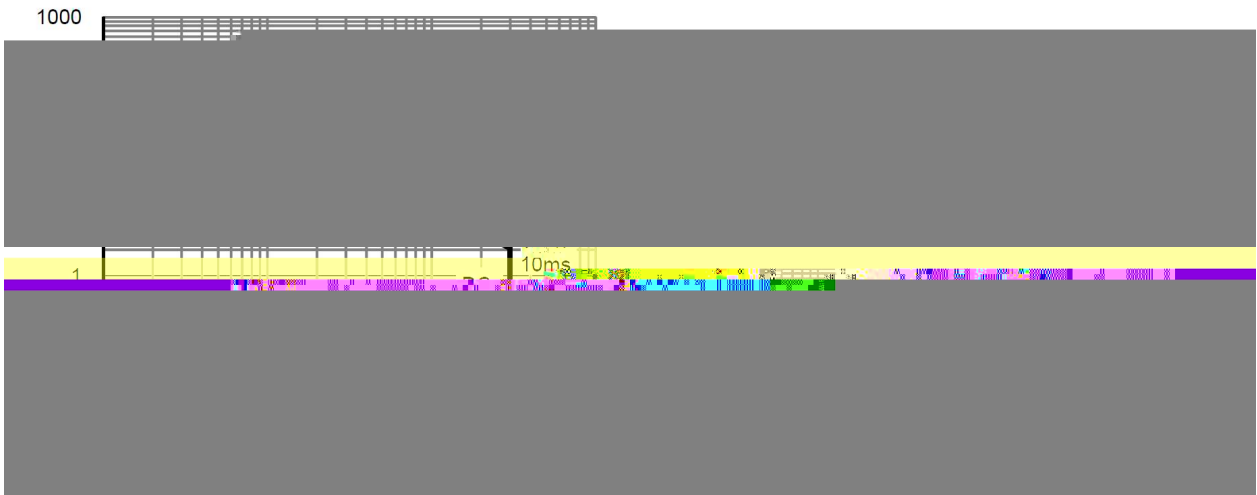
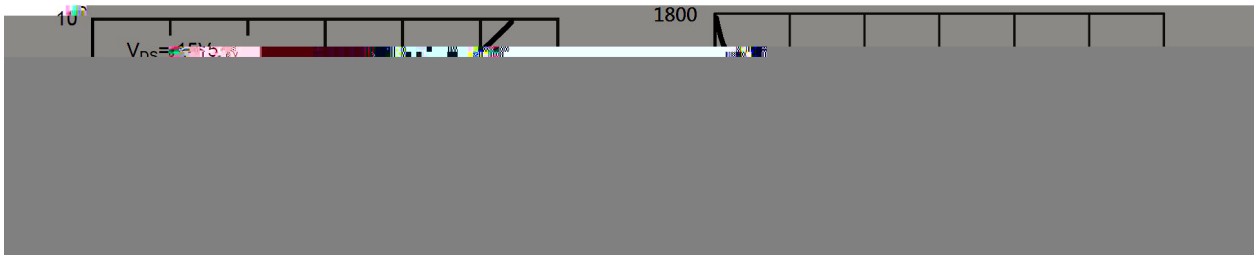

/ Package Dimensions

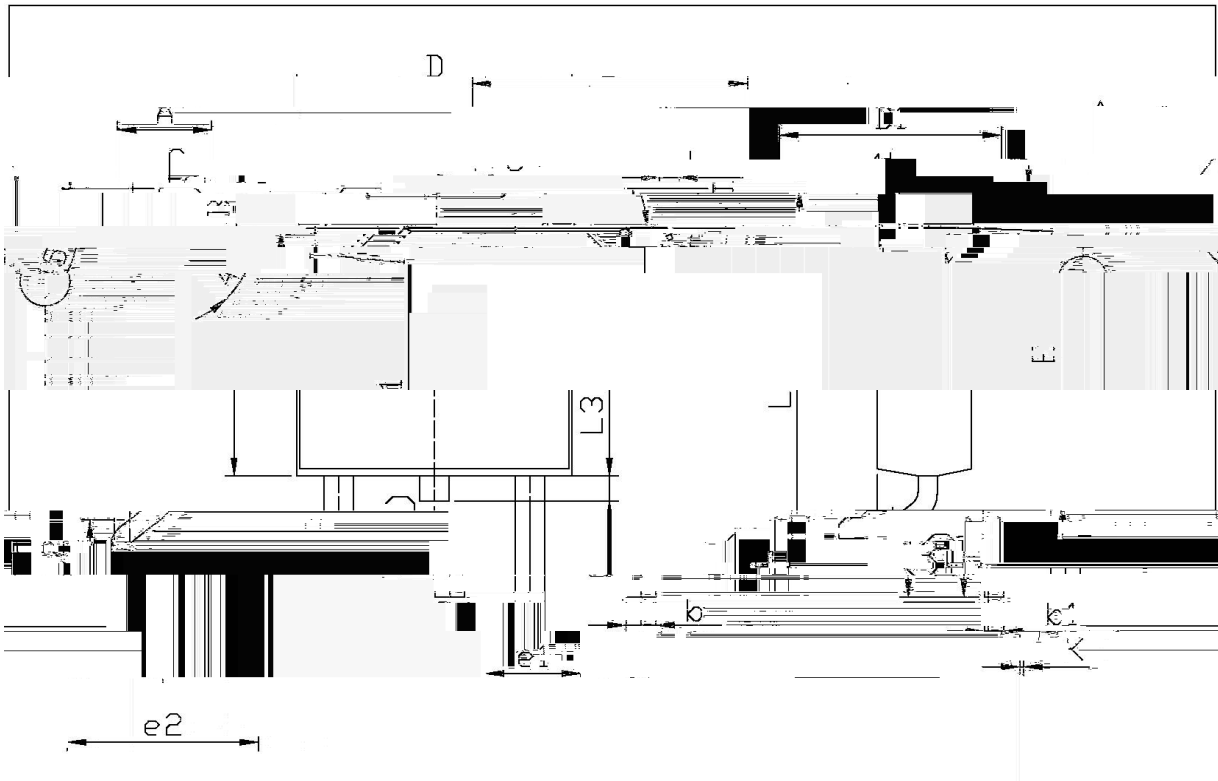

Scale: 1:1

| Dimension | Symbol | Value | Unit |
|-----------|--------|-------|------|
| B | 0.95 | 1.25 | mm |
| e1 | 2.24 | 2.34 | mm |
| e2 | 9.85 | 10.35 | mm |
| b | 0.45 | 0.55 | mm |
| k1 | 6.45 | 6.75 | mm |
| L3 | 0.60 | 0.60 | mm |

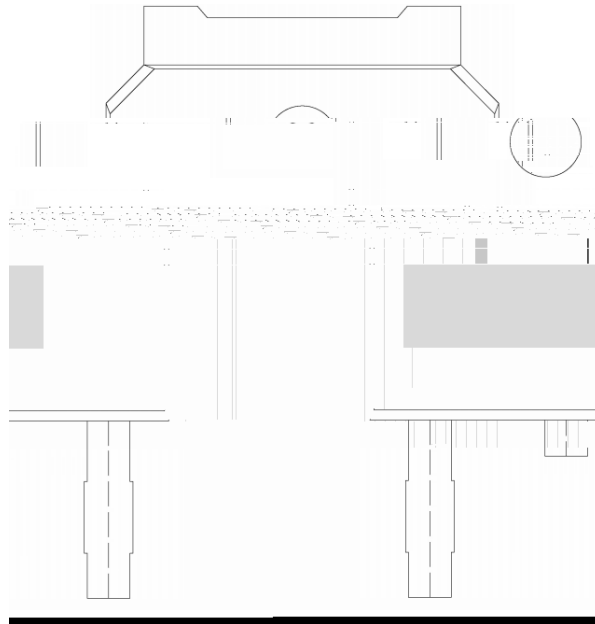

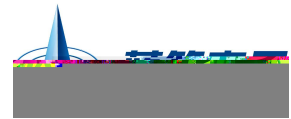

() / Temperature Profile for IR Reflow Soldering(Pb-Free)

| |
|--|
| |
| |
| |
| |
| |
| |
| |

Note:

- | | | | |
|---|---------|-----------|---|
| 1 | 150 180 | 60 90sec; | 1.Preheating:150~180 , Time:60~90sec. |
| 2 | 245±5 | 5±0.5sec; | 2.Peak Temp.:245±5 , Duration:5±0.5sec. |
| 3 | 2 10 | /sec. | 3. Cooling Speed: 2~10 /sec. |

/ Resistance to Soldering Heat Test Conditions

260±5 10±1 sec. Temp.:260±5℃ Time:10±1 sec

/ Packaging SPEC.

/ REEL

| Package Type 封装形式 | Units 包装数量 | | | | | Dimension 包装尺寸 (unit: mm ³) | | |
|----------------------|--------------------|-------------------------|------------------------|------------------------------|------------------------|---|-------------|-------------|
| | Units/Reel 只/卷盘 | Reels/Inner Box 卷盘/盒 | Units/Inner Box 只/盒 | Inner Boxes/Outer Box 盒/箱 | Units/Outer Box 只/箱 | Reel | Inner Box 盒 | Outer Box 箱 |
| TO-252 | 2,500 | 2 | 5,000 | 6 | 30,000 | 13" ×16 | 360×360×50 | 380×335×366 |

/ TUBE

| Package Type 封装形式 | Units 包装数量 | Dimension 包装尺寸 (unit: mm ³) |
|----------------------|------------|---|
|----------------------|------------|---|