

Rev.A Jun.-2022



Rev.A Jun.-2022

SOT-23 N MOS
N- CHANNEL MOSFET in a SOT-23 Plastic PackageA



Rev.A Jun.-2022

| Parameter | Symbol | Rating | Unit |
|----------------------------|-----------|---------|------|
| Drain-Source Voltage | V_{DSS} | 20 | V |
| Gate-Source Voltage | V_{GSS} | ± 8 | V |
| Drain Current – Continuous | I_D | 3.0 | A |
| Pulsed Drain Current | I_{DM} | 10 | A |
| Continuous Source Current | I_S | 0.95 | A |
| Power Dissipation | P_D | 0.9 | W |
| Storage Temperature | | | |



Rev.A Jun.-2022

SECTION 3-3

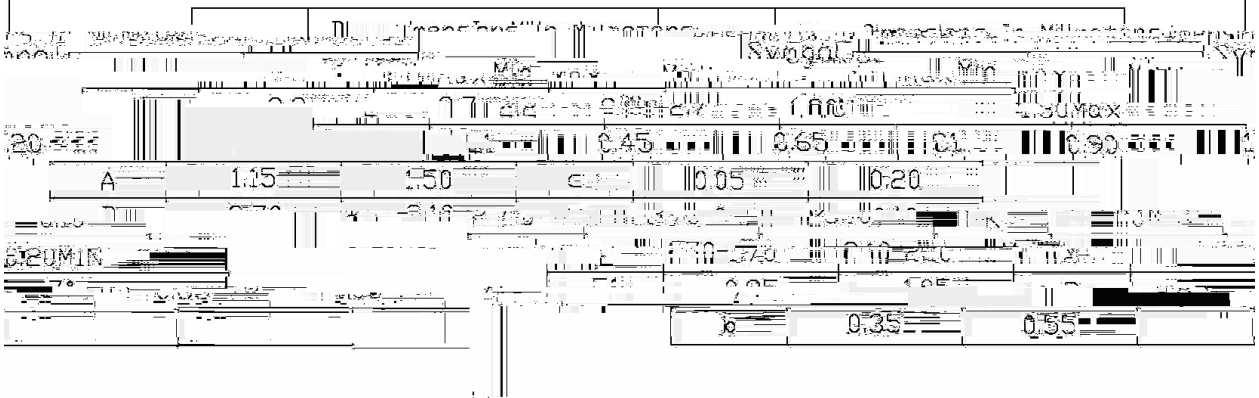
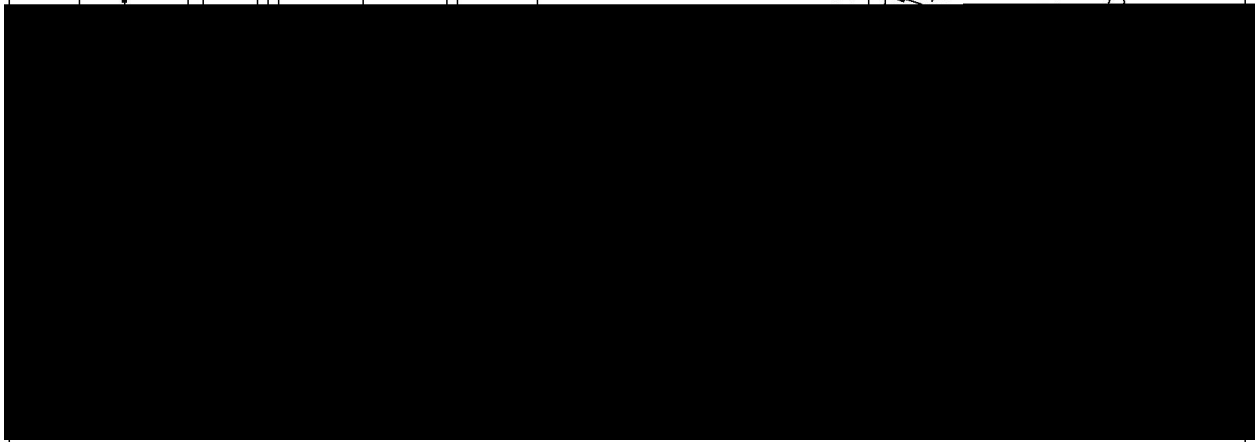
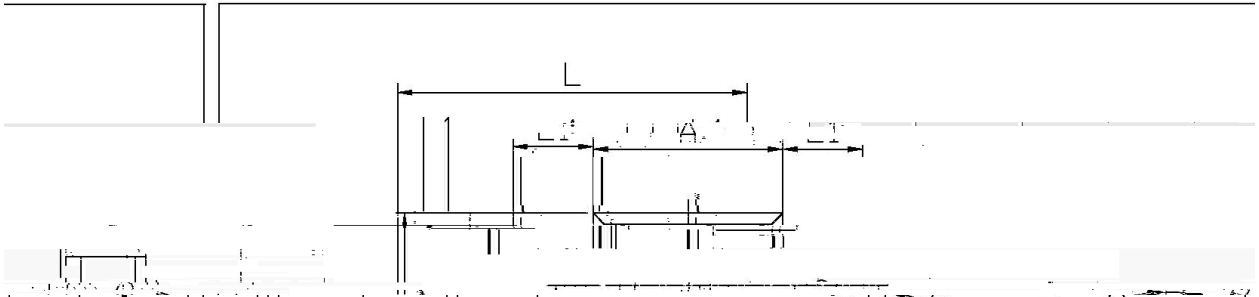

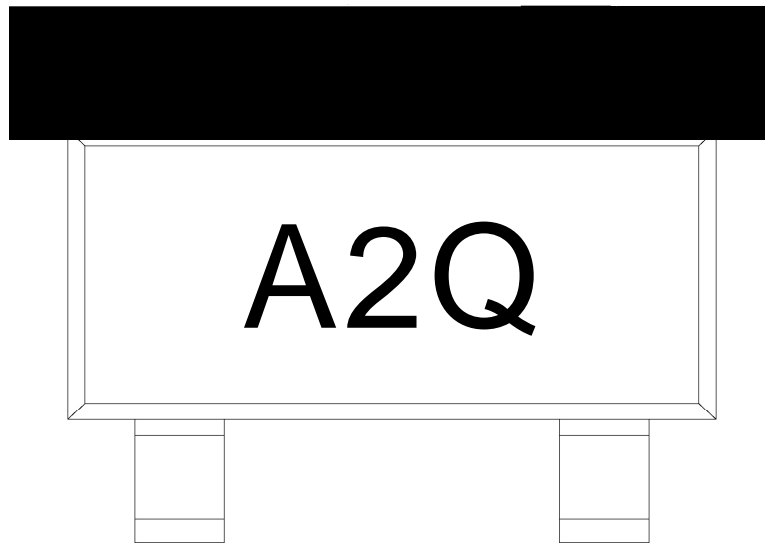

A2:

Q

Note:

A2 Product Type Code

Q: Automobile halogen-free product Code



kgdl Temperature Profile for IR Reflow Soldering(Pb-Free)

| |
|--|
| |
| |
| |
| |
| |
| |
| |

Note:

- 1 150 200 60 120sec; 1.Preheating:150~200°C, Time:60~120sec.
- 2 255±5 5±0.5sec; 2.Peak Temp.:255±5°C, Duration:5±0.5sec.
- 3 2 10°C/sec. 3. Cooling Speed: 2~10°C/sec.

7 J T J E 4 0 9 I 5 9 5 . 2 0 . 0 9 4 6 0 0 T m / F 8