

Parameter	Symbol	Rating	Unit
Peak Pulse Power($t_p = 8/20\mu s$)	P_{PK}	120	W
Peak Pulse Current($t_p = 8/20\mu s$)	I_{PP}	6	A
ESD according to IEC61000-4-2 air discharge	V_{ESD}	± 30	KV
ESD according to IEC61000-4-2 contact discharge		± 30	
Junction temperature	T_J	125	
Operating temperature	T_{OP}	-40~85	

Parameter	Symbol	Test Conditions	Min	Typ	Max	Unit
Reverse maximum working voltage	V_{RWM}	RWM 9-0 2225TD -1.720661.0004 0	0	$V_{TD}()$	1.3891 -1J/TT7Tf9.79 4804.0	

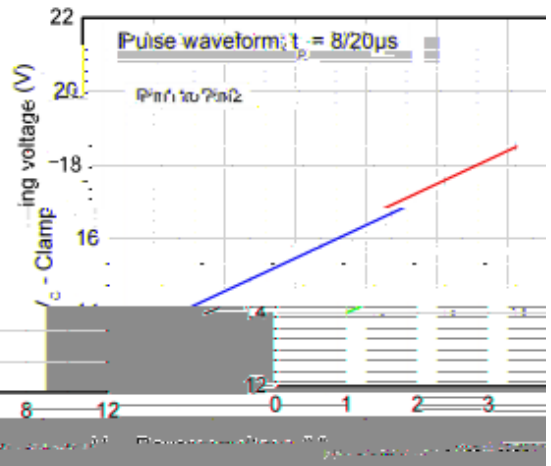
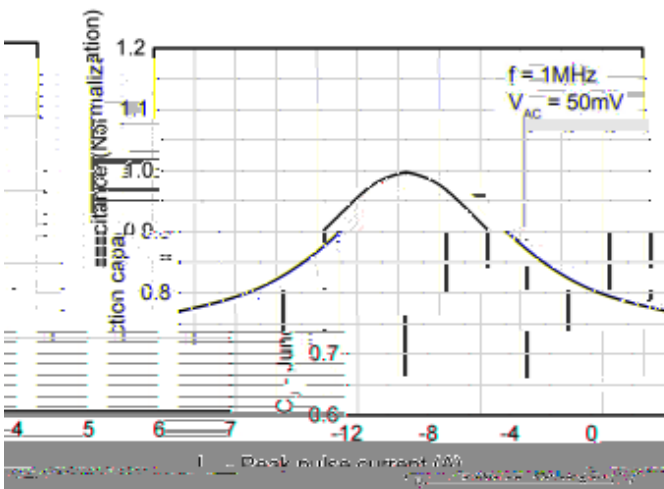

Peak current

Capacitance vs. Reverse voltage

Clamping voltage vs. Peak p

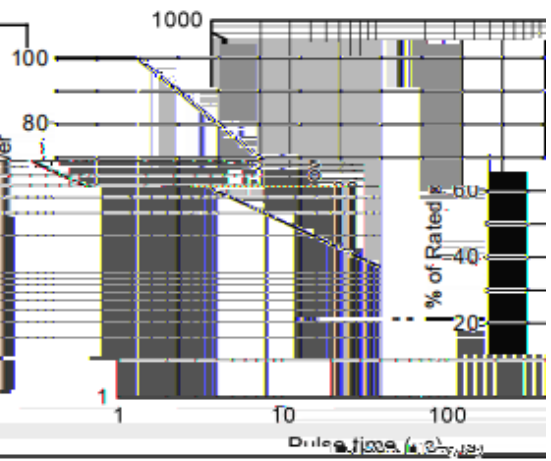
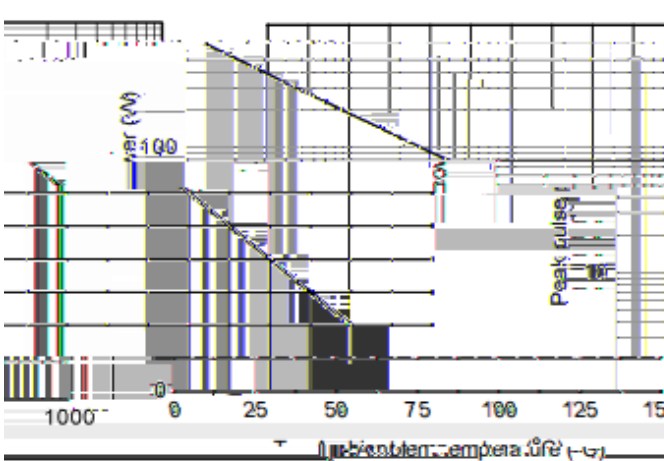

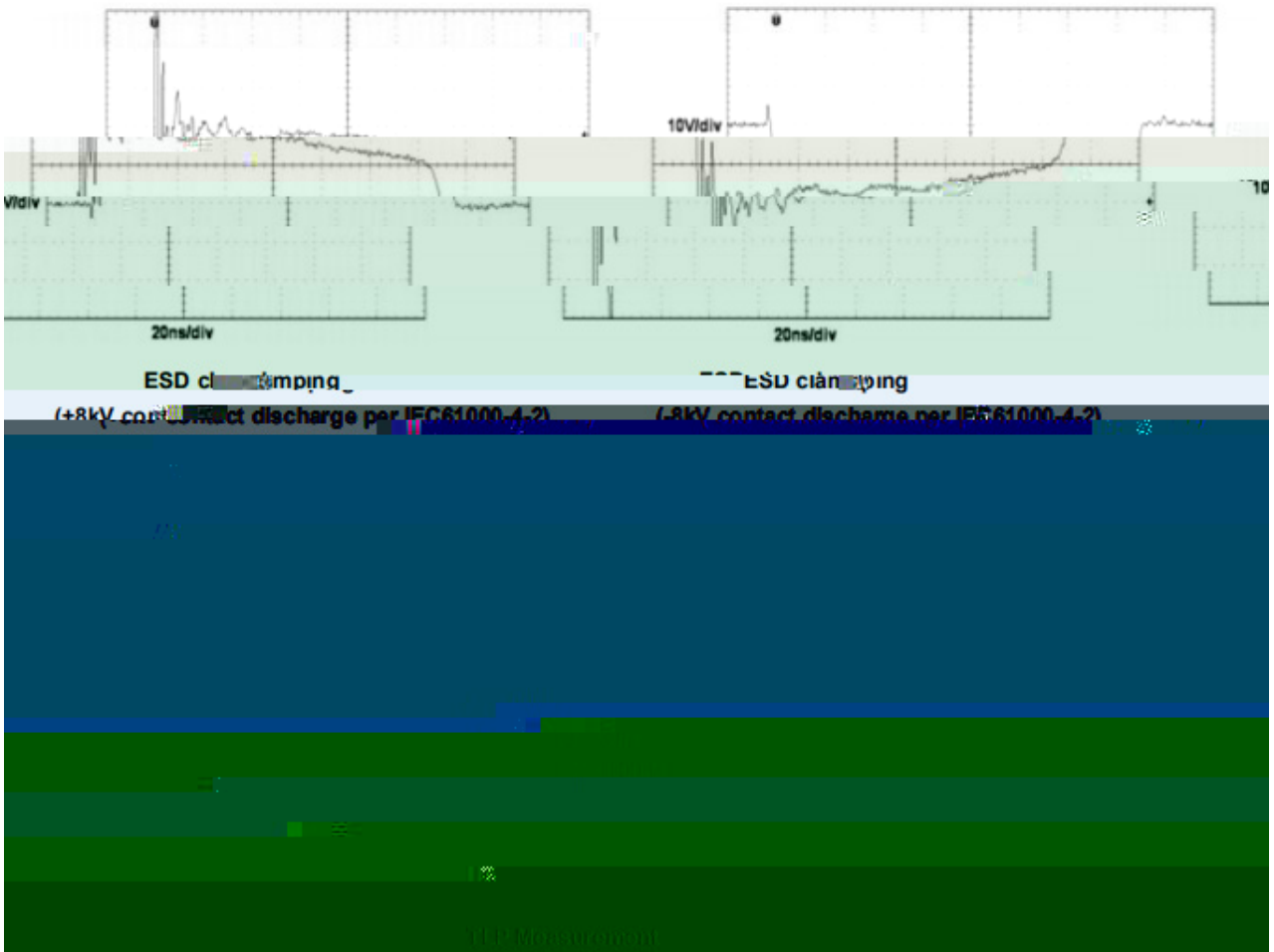

DFN1006-2L

Unit:mm

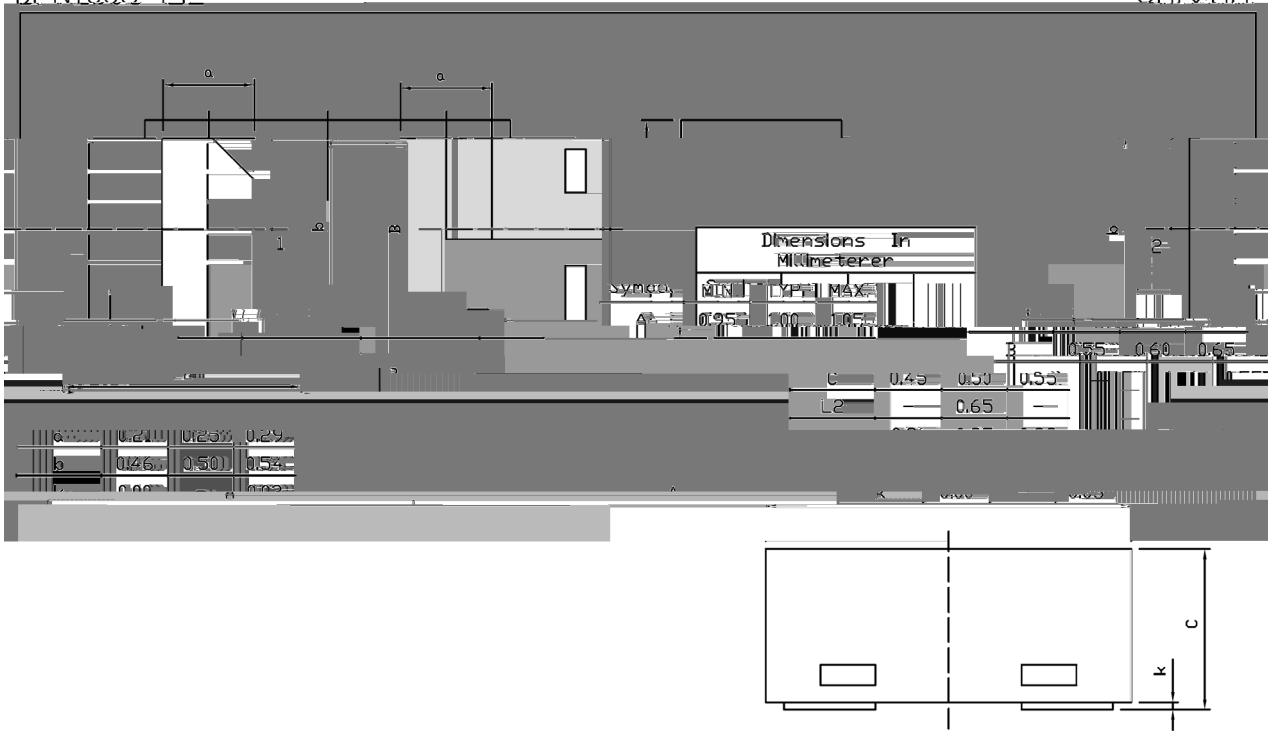

Rev.01 202108



Temperature Profile for IR Reflow Soldering(Pb-Free)

Note:

- | | | | |
|---|-----------|--------------|---|
| 1 | 150 ~ 200 | 60 ~ 120sec; | 1.Preheating:150~200 , Time:60~120sec. |
| 2 | 255±5 | 5±0.5sec; | 2.Peak Temp.:255±5 , Duration:5±0.5sec. |
| 3 | 2 ~ 10 | /sec. | 3. Cooling Speed: 2~10 /sec. |

260±5	10±1 sec.	Temp.:260±5	Time:10±1 sec
-------	-----------	-------------	---------------

/ REEL

Package Type	Units	Dimension	(unit mm ³)
--------------	-------	-----------	-------------------------