

/ Descriptions

JF K\$/O GE G`

/ Features

(N # BK: +* . ,

/ Applications

/ Equivalent Circuit

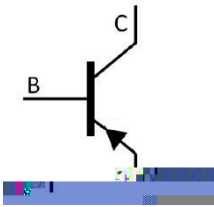

/ Pinning

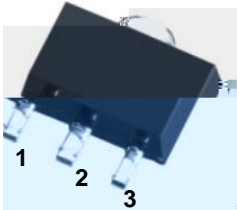

/ Marking

	* *	* *

x

						μ
						μ

/ Electrical Characteristic Curve

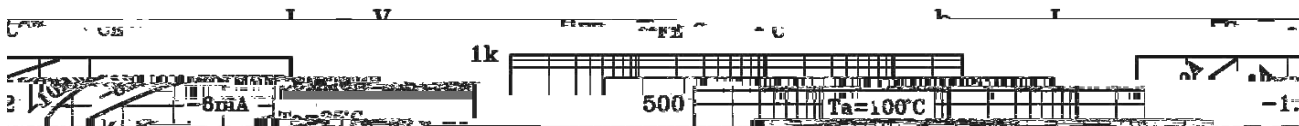

/ Package Dimensions

SOT-89

单位: mm

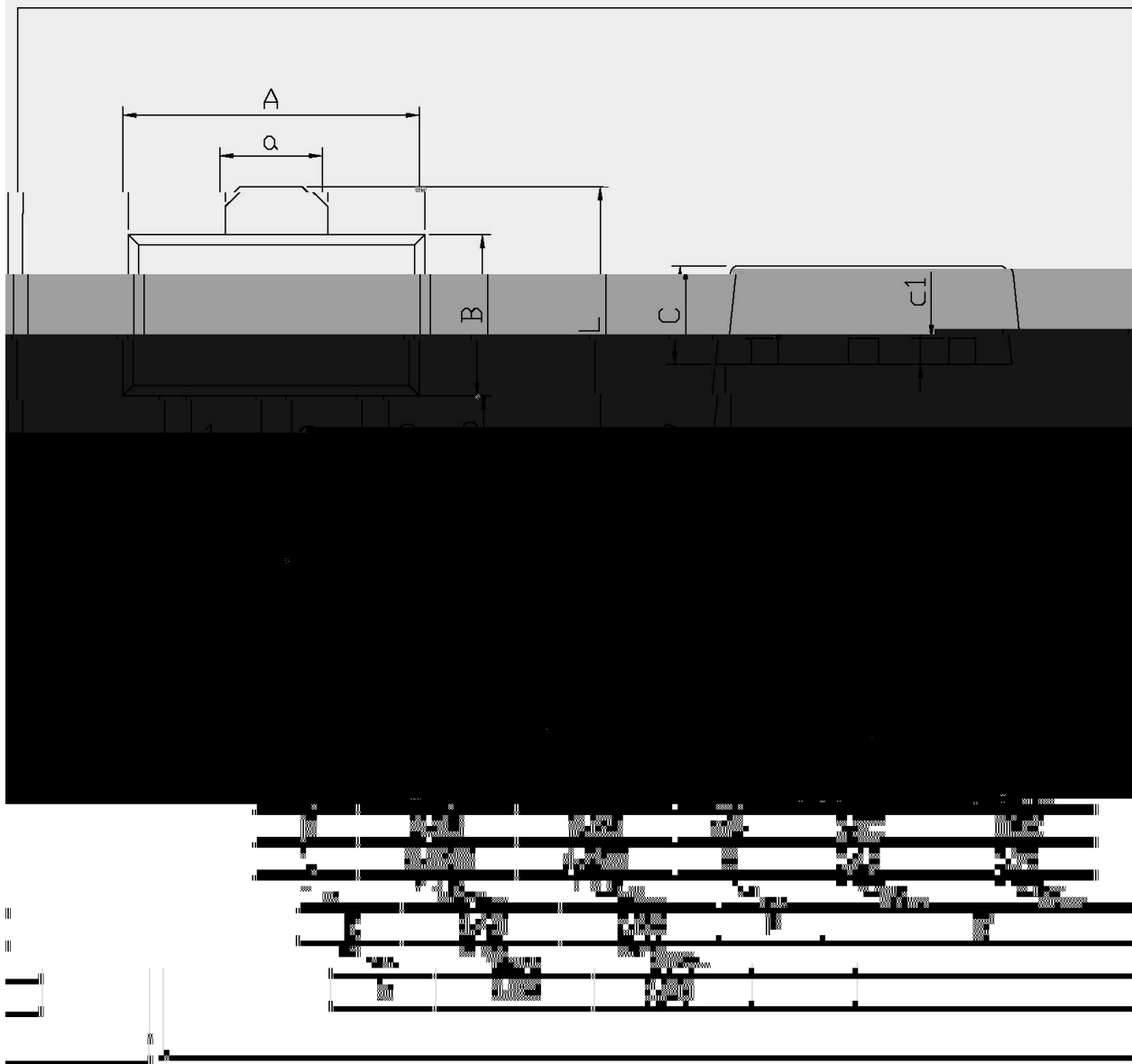

/ Marking Instructions

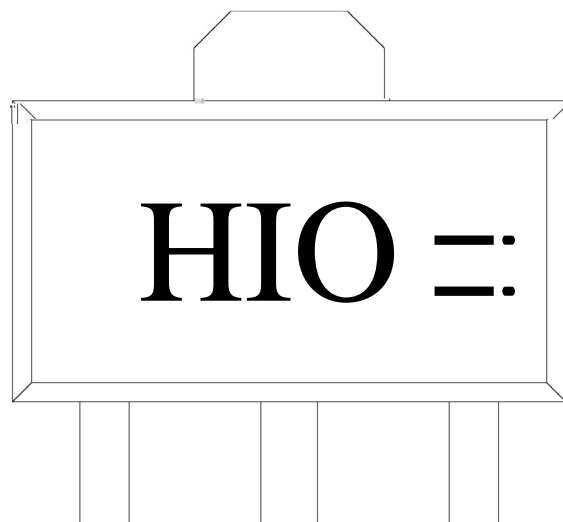

?

@

F 1 _=<

!!

() / K\ d g\ i Xk\ i \ Gif] \ d] fi @ ' I \] f n J f d \ i e ^ Z G Y \$ = i \ \ z

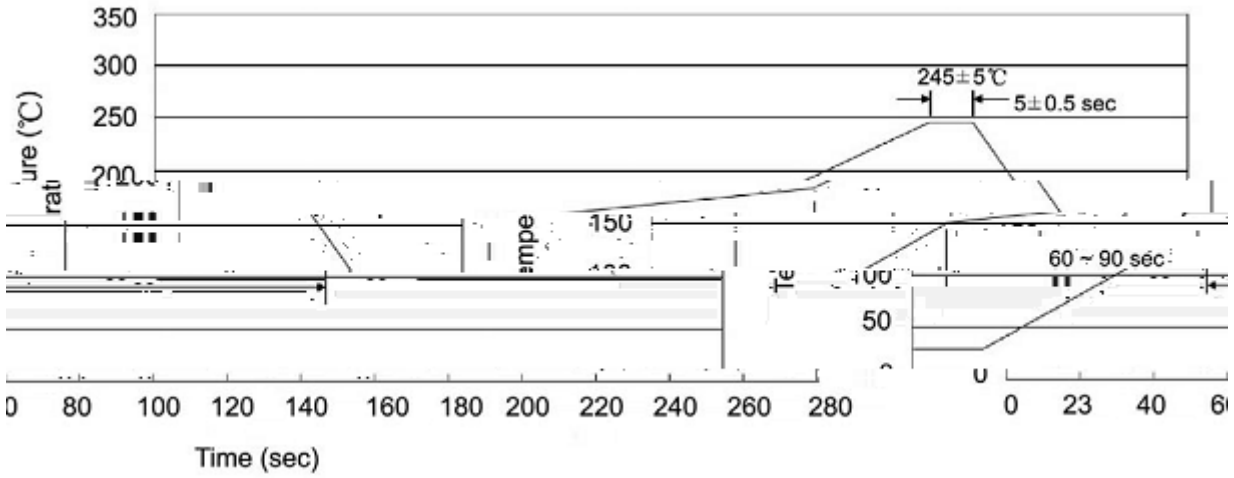

/ Resistance to Soldering Heat Test Conditions

/ Packaging SPEC.

	Units/Reel	Reels/Inner Box	Units/Inner Box	Inner Boxes/Outer Box	Units/Outer Box	Reel	Inner Box	Outer Box
SOT-89	1,000	7	7,000	8	56,000	7 ×12	180×120×180	385×257×392

/ Notices