

# MBRD10100CT

Rev.H Aug.-2025

## / Descriptions

Schottky Diode in a TO-252 Plastic Package.

## / Features

Low power loss, high efficiency, HF Product.

## / Applications

For use in low voltage, high frequency inverters, free wheeling, and polarity protection applications.

## / Equivalent Circuit

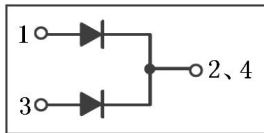

## / Pinning

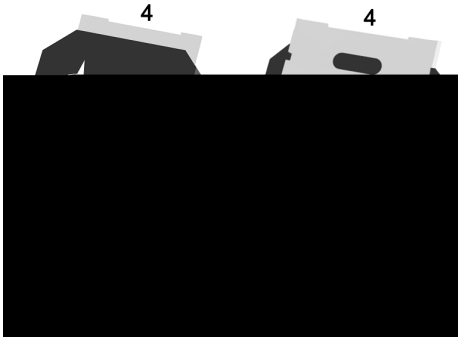

PIN1 Anode

PIN 2,4 Cathode

PIN 3 Anode

## / Marking

See Marking Instructions.

# MBRD10100CT

Rev.H Aug.-2025



DATA SHEET

Parameter	Symbol	Rating	Unit
Peak Repetitive Reverse Voltage Working Peak Reverse Voltage DC Blocking Voltage	$V_{RRM}$ $V_{RWM}$ $V_{RM}$	100	V
RMS Reverse Voltage	$V_{R(RMS)}$	70	V
Average Rectified Forward Current	$I_{F(AV)}$	2× 5	A
Non Repetitive Peak Surge Current	$I_{FSM}$	125	A
Thermal resistance, junction to case	$R_{Jc}$	6.5	/W
Junction Temperature Range	$T_{jMAX}$	150	
Storage Temperature Range	$T_{stg}$	-55 150	

Parameter	Symbol	Test Conditions	Min	Typ	Max	Unit
Reverse Voltage	$V_{BR}$	$I_R=0.3mA$	100			V
Forward Voltage	$V_F$	$I_F=5A$ $T_J=25$			0.85	V
		$I_F=5A$ $T_J=125$			0.75	V
		$I_F=10A$ $T_J=25$			0.95	V
		$I_F=10A$ $T_J=125$			0.85	V
Instantaneous Reverse Current	$I_R$ Note 1	$V_R=100V$ $T_J=25$			10	uA
		$V_{RPea4}$ 314 339.7404 $T_m(R)$ $T_j$ 10.49580 741 $T_f$ 77.02 343.98 358.700				

**/ Electrical Characteristic Curve**

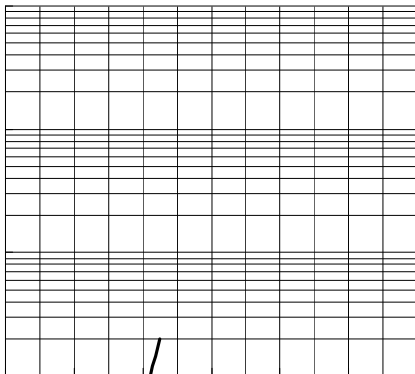
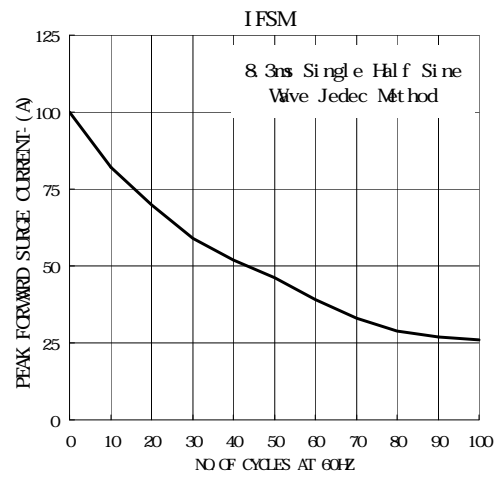
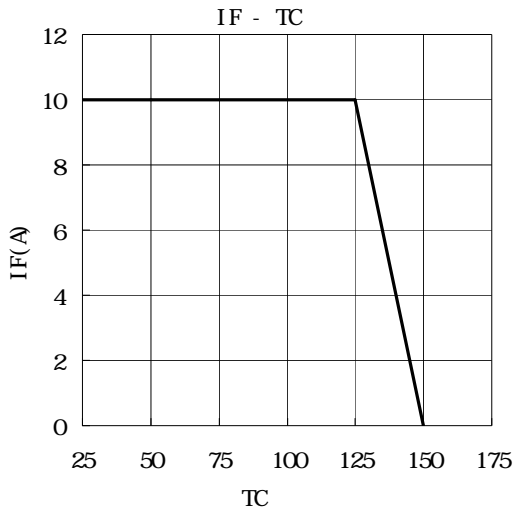

**/ Package Dimensions**

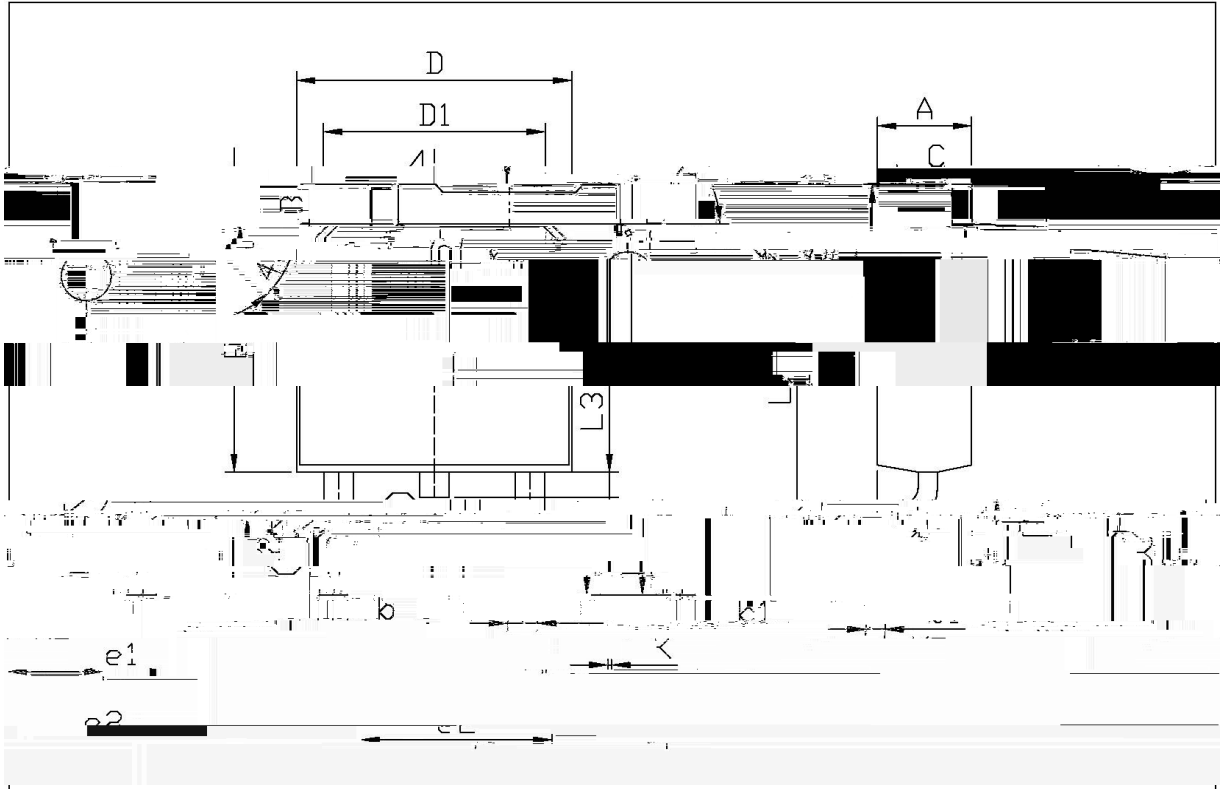

单位: mm

Dimensions		Millimeters		Dimensions		In Millimeters	
Symbol	Max	Min	Symbol	Max	Symbol	Max	Min
B	5.00	3.10	e1	2.24	e2	2.24	
L3	0.70	0.60	K	9.95			
D	10.15	8.55	D1	6.75	5.50	6.00	

T0-252

# MBRD10100CT

Rev.H Aug.-2025



蓝箭电子  
BLUE ROCKET ELECTRONICS

DATA SHEET

## / Marking Instructions

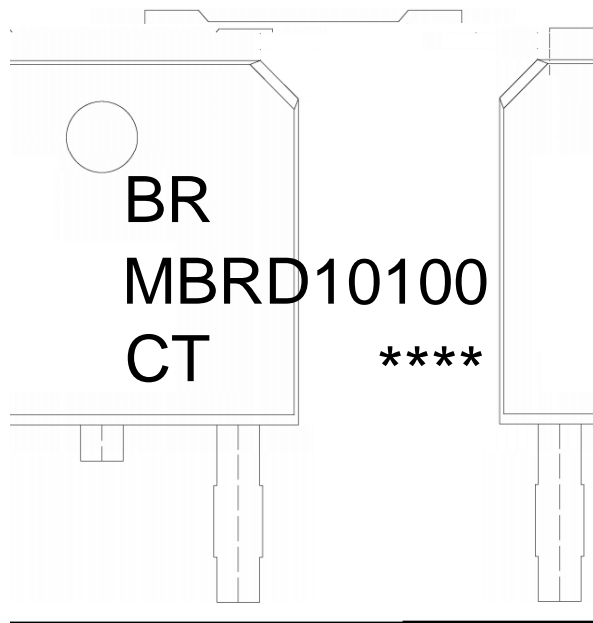

Note:

BR:	Company Code
MBRD10100	Product Type Code
CT:	Internal Structure
****:	Lot No. Code, code change with Lot No.

# **MBRD10100CT**

Rev.H Aug.-2025