



Parameter	Symbol	Rating	Unit
Collector to Base Voltage	$V_{CBO}$	100	V
Collector to Emitter Voltage	$V_{CEO}$	100	V
Emitter to Base Voltage	$V_{EBO}$	5	V
Collector Current - Continuous	$I_C$	6	A
Peak Collector Current	$I_{CP}$	10	A
Base Current - Continuous	$I_B$	2	A
Collector Power Dissipation	$P_C$	2	W
Collector Power Dissipation	$P_C (T_c=25 \text{ }^\circ\text{C})$	65	W
Junction Temperature	$T_j$	150	
Storage Temperature Range	$T_{sag}$	-55 150	

Parameter	Symbol	Test Conditions	Min	Typ	Max	Unit
Collector to Emitter Breakdown V						

**TIP41CB**  
Rev.F May.-2016

/ Package Dimensions

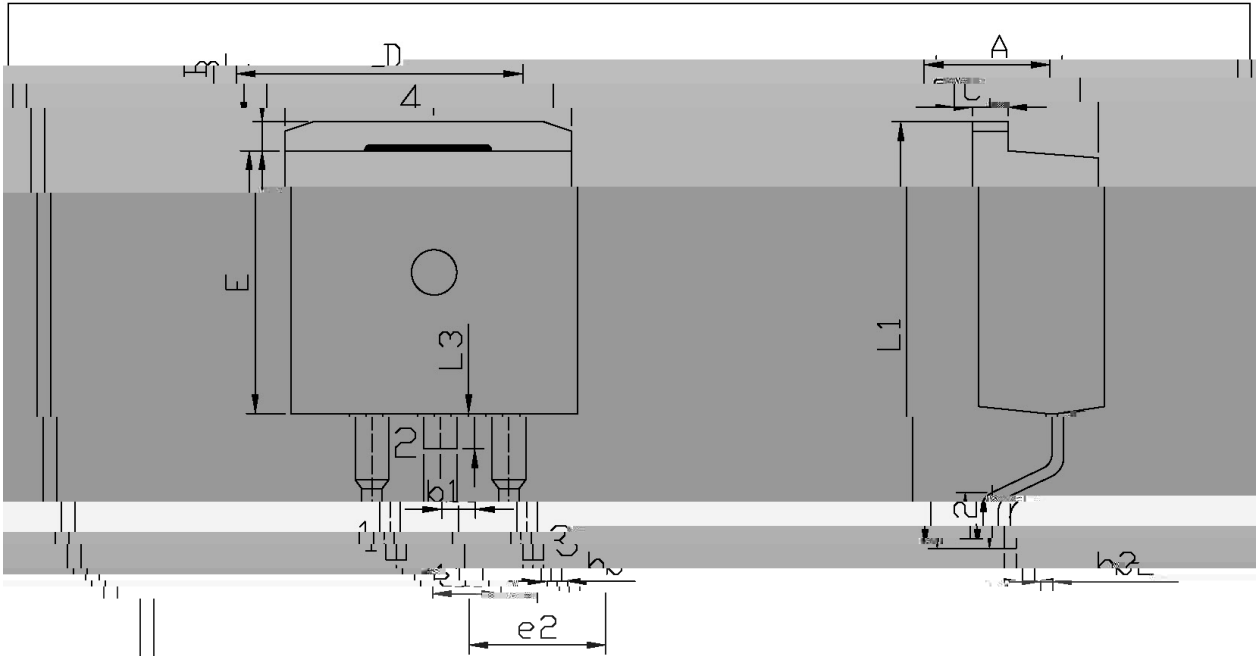

单位: mm

Dimensions in Millimeters

Symbol	Min	Max	Symbol	Min	Max
A	4.30	4.70	E	9.00	9.40
B	1.00	1.40	d1	2.30	2.70





( ) / Temperature Profile for Dip Soldering(Pb-Free)

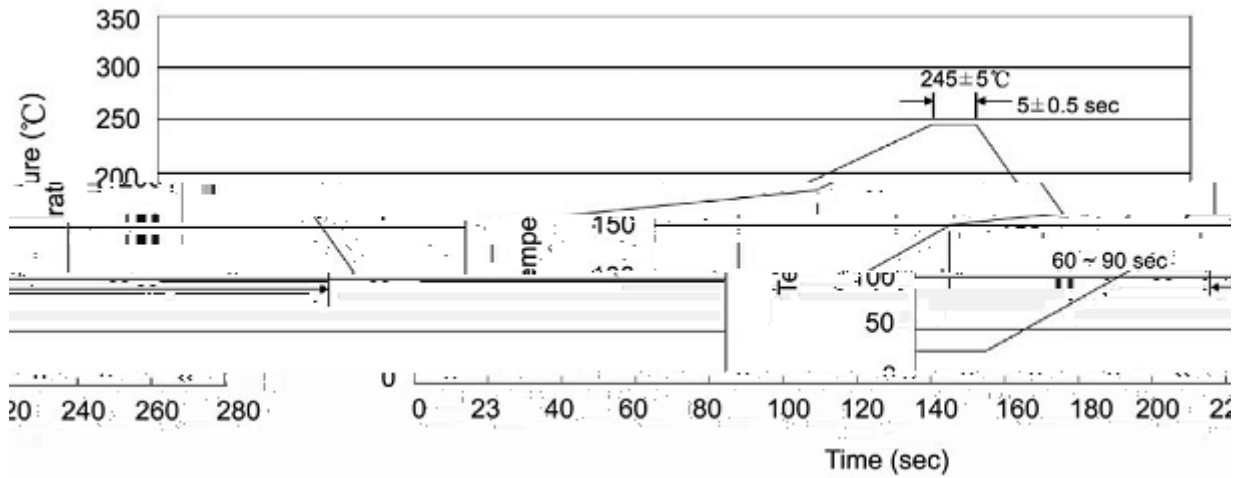

Note:

- |   |        |     |            |          |   |
|---|--------|-----|------------|----------|---|
| 1 | 25     | 150 | 60         | 90sec;   | 1.Preheating:25~150 , Time:60~90sec.      |
| 2 | 245..5 |     | 5..0.5sec; |          | 2.Peak Temp.:245..5 , Duration:5..0.5sec. |
| 3 |        |     | 2          | 10 /sec. | 3. Cooling Speed: 2~10 /sec.              |

/ Resistance to Soldering Heat Test Conditions

260..5                      10..1 sec.                      Temp.:260±5                      Time:10±1 sec

/ Packaging SPEC.

/ REEL

Package Type	Units					Dimension (unit mm <sup>3</sup> )		
	Units/Reel	Reels/Inner Box	Units/Inner Box	Inner Boxes/Outer Box	Units/Outer Box	Reel	Inner Box	Outer Box
TO-263	800	1	800	5	4,000	13 ×24	360×360×50	385×257×392

/ TUBE

Package Type	Units					Dimension (unit mm <sup>3</sup> )		
	Units/Tube	Tubes/Inner Box	Units/Inner Box	Inner Boxes/Outer Box	Units/Outer Box	Tube	Inner Box	Outer Box
TO-263	50	20	1,000	5	5,000	532×33×7.0	555×164×50	575×290×180

/ Notices